

IPSD – 50 DIFFERENTIAL PRESSURE SWITCHES

Operating Function

Industrial Differential Pressure Switch (IPSD-50) is an electromechanical device that senses changes in pressure difference between two pressure lines and provides electrical contact closures at predetermined values.

Applications

These switches are normally used on pressure lubricated system across the filter to get an indication or alarm when the filter gets choked. It can also be used to stop the pump or energise / de-energise another electric circuit depending upon the actual application.

It is designed for use with oil, air, water and low temperature steam. It is not designed for refrigerant gases.

Setting

The lower changeover is set on the scale by rotating the pressure setting disc inside the control. Clockwise rotation of the setting disc reduces the set differential pressure and vice versa. The higher changeover is achieved by adding the contact differential (2.8 PSI fixed) to the lower changeover. The setting disc is visible after removing front cover. It is placed just below the LP bellows between the LP bellows and main spring.

Fitting

IPSD Differential Pressure Switch can be fitted in any position. It can be mounted directly or on panel by means of mounting holes in the back of the device.

The upper bellows is the low pressure element and must be connected to lower pressure circuit.

The lower bellows is the high pressure element and must be connected to higher pressure circuit.

Functioning example

IPSD Differential Pressure Switch can be used, to monitor choking of filters in a lubrication system.

High pressure bellows can be connected to the inlet of the filter and LP side bellows to the outlet of the filter. The differential can be set at desired differential pressure which is adjustable between 4.3 to 64 PSI.

As soon as the pressure difference between the inlet and the outlet increases above the set difference of pressure by 2.8 PSI, the switch will operate and changeover will take place to give a signal. It will changeover again when the difference of pressure falls to the set difference of pressure to stop the signal.

GENERAL SPECIFICATION

Enclosure	Painted Mild Steel to IP:33 as per IS:13947 (Part-1), 1993
Range	4.3 to 64 PSI (0.3 to 4.5 atm)
Differential	2.8 PSI (0.2 atm), Fixed
Maximum Pressure	313 PSI (22 atm)
Sensing Element	Stainless Steel Bellows
Switching	1 SPDT Microswitch
Switch Rating	5A, 125/250V AC, 0.2A 250V DC
Repeatability / Accuracy	± 2% FSR
Ambient Temperature	70°C
Process Temperature	100°C max.
Process Connection	3/8" BSP (M)
Cable Entry	Suitable for 6 to 14 mm dia Cable
Mounting	Surface / Panel
Code No.	060D9002

MOUNTING DIMENSIONS

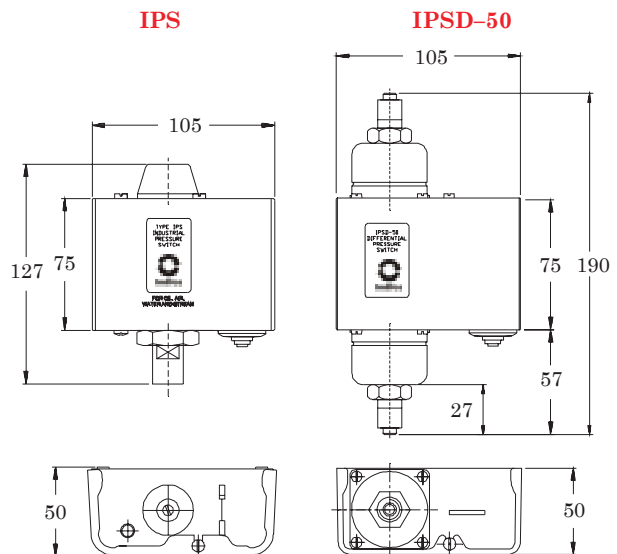

All dimensions are in mm

This is not a contractual document. Prior notification of changes in specifications is impracticable due to continuous improvement



Indfos Industries Limited

Regd. Off : 2749, Street No.13, Ranjith Nagar, New Delhi 110 008

web-site : www.indfos.com

WORKS

1. B20, Industrial Area, Site 3, Meerut Road, Ghaziabad (UP) 201 003
Ph : 0120-2712016 / 2712134 Fax : 0120-2712023 E-mail : sales@indfos.com

2. 86, Thirupoor Kumaran Street, Athipet, Ambattur, Chennai 600 058

SALES	E-MAIL	PHONE	FAX
Chennai	chennai@indfos.com	044-2435 3407	044-2431 1760
Coimbatore		9486191368	
Delhi	delhi@indfos.com	011-2589 7296	011-4500 9460
Kolkata	kolkata@indfos.com	033-2486 6761	033-2486 6761
Mumbai	mumbai@indfos.com	022-2565 6936	022-2569 1237



#1110 IPS/IPSD-Pre-2*